

# METAL CAVITY ANCHOR SETS

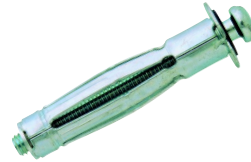

Light duty fixing for use in plasterboard and panels such as MDF, plywood and hardboard. Fixing is set independently of fixture. The fixture can be removed leaving the fixing in place for re-use. Ideal for radiator brackets, curtain poles and track, wooden battens, electrical fittings and trunking. A setting tool is available to speed up installation.

Size do x L	Code	Price Per 100	Tfix	Lv	d	L	h min- h max	do	Box qty	Outer
M4x32	MCA04032	£27.43	10	38	M4	32	3--10	8	100	2000
M4x38	MCA04038	£32.24	15	45	M4	38	10--16	8	100	2000
M5x37	MCA05037	£33.96	15	45	M5	37	8--13	11	100	1200
M5x52	MCA05052	£39.78	25	58	M5	52	8--16	11	100	1200
M5x65	MCA05065	£45.90	25	71	M5	65	19--32	11	100	600
M6x37	MCA06037	£53.15	15	45	M6	37	8--13	13	100	1200
M6x52	MCA06052	£58.30	25	58	M6	52	8--16	13	100	600
M6x65	MCA06065	£63.44	25	71	M6	65	19--32	13	100	600

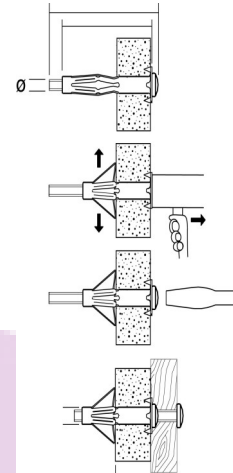

- Lv Screw Length (mm)
- do Drill hole diameter (mm)
- d Screw diameter (mm)
- hmin Minimum wall/board thickness (mm)
- hmax Maximum wall/board thickness (mm)
- L Anchor body length (mm)

# METAL CAVITY ANCHOR SETTING TOOL

Heavy duty setting tool for metal cavity anchor sets, one complete pull on the setting tool sets all sizes, speeding up installation.

Type	Code	Price Per 100	Box qty
CA TOOL	MCATOOL1	£30.18	1



All dimensions in mm, unless otherwise stated.