

# NYLON PLUGS

Light duty fixing for use in solid or hollow brickwork, solid or hollow blockwork, hard stone and concrete. Made from Nylon the plug do not age harden as Plastic plugs do, they also have a higher resistance to temperature change. Ideal for electrical and plumbing fittings, trucking, shelving, wooden battens, signs and light duty brackets.

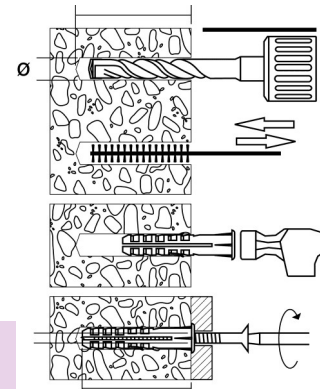
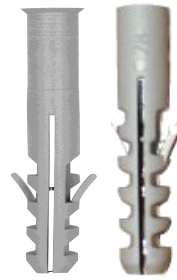

Size do x L	RIMMED Code	RIMLESS Code	Price Per 100	do	L	d gauge min-max	d metric min-max	h1	hnom	Box qty
Ø 5x25	NP05025R	NP05025	£4.11	5	25	4--8	2.5--4	35	25	200
Ø 6x30	NP06030R	NP06030	£5.49	6	30	6--10	3.5--5	40	30	200
Ø 7x35	NP07035R	NP07035	£6.86	7	35	8--12	4.5--5	40	30	200
Ø 8x40	NP08040R	NP08040	£8.23	8	40	10--14	5--6	50	40	100
Ø 10x50	NP10050R	NP10050	£15.10	10	50	14--18	6--8	60	50	100
Ø 12x60	NP12060R	NP12060	£28.80	12	60	18--24	8--10	70	60	50
Ø 14x75	NP14075R	NP14075	£43.20	14	75	24--32	10--12	90	75	50
Ø 14x100	NP14100R	NP14100	£49.68	14	100	24--32	10--12	90	75	50
Ø 14x135	NP14135R	NP14135	£97.20	14	135	24--32	10--12	90	75	20
Ø 16x80	NP16080R	NP16080	£66.84	16	80	32-40	12--14	95	80	10

- L Anchor Body Length (mm)
- d Anchor Thread Length (mm)
- do Drill hole diameter (mm)
- hnom Anchor Embedment depth (mm)
- h1 Depth of drilled hole deepest point (mm)

# UNIVERSAL PLUGS

Light duty fixing for use in plasterboard, hollow doors and panels such as MDF, plywood and hardboard. The universal plug is also suitable for use in solid or hollow brickwork, solid or hollow blockwork, hard stone and concrete. Ideal for radiator brackets, pipe clips and clamps, shelves, kitchen brackets, curtain poles and track, wooden battens, electrical fittings and trunking.



Size do x L	Code	Price Per 100	do	L	d metric min-max	Lv min	Box qty	Outer
Ø 6x30	NUP06030	£12.34	6	30	3--4.5	35	200	9600
Ø 8x50	NUP08050	£17.83	8	50	3.5--6	55	100	7200
Ø 10x60	NUP10060	£20.57	10	60	6--8	65	50	3600

- L Anchor Body Length (mm)
- d Anchor Thread Length (mm)
- do Drill hole diameter (mm)
- Lv Screw length minimum (mm)

# NYLON MULTI PLUG

Light duty fixing for use in plasterboard, hollow doors and panels such as MDF, plywood and hardboard. The Nylon multi plug is also suitable for use in solid or hollow brickwork, solid or hollow blockwork, hard stone and concrete. Ideal for radiator brackets, pipe clips and clamps, shelves, kitchen brackets, curtain poles and track, wooden battens, electrical fittings and trunking.



Size do x L	Code	Price Per 100	do	L	d metric min-max	Lv min	Box qty	Outer
Ø 6x30	NMP06030	£6.57	6	30	3--4.5	35	200	9600
Ø 8x40	NMP08040	£9.87	8	40	3.5--6	55	100	7200
Ø 10x50	NMP10050	£18.14	10	50	6--8	65	50	3600

- L Anchor Body Length (mm)
- d Anchor Thread Length (mm)
- do Drill hole diameter (mm)
- Lv Screw length minimum (mm)

All dimensions in mm, unless otherwise stated.