

SLEEVE ANCHORS

Medium duty all purpose through fixing for use in brickwork, blockwork, hard stone and concrete.

Ideal for garage doors, hand rails, joist hangers, wall plates, racking, signs, shelves, satellite dishes and stadium seating

SLNZ— NUT TYPE SLEEVE ANCHOR

Size do x Lt	Code	Price Per 100	Tfix	L	d	do	h1	hnom	hmin	Tinst Nm	Box qty	Outer
Ø 8x40	SLNZ08040	£46.49	5	40	M6	8	40	35	60	10	100	1200
Ø 8x65	SLNZ08065	£60.10	30	65	M6	8	40	35	60	10	100	1200
Ø 8x92	SLNZ08092	£77.11	57	92	M6	8	40	35	60	10	50	600
Ø 10x50	SLNZ10050	£62.37	10	50	M8	10	45	40	70	25	50	600
Ø 10x77	SLNZ10077	£77.11	37	77	M8	10	45	40	70	25	50	600
Ø 10x97	SLNZ10097	£102.06	57	97	M8	10	45	40	70	25	50	600
Ø 12x58	SLNZ12058	£95.26	8	58	M10	12	55	50	90	40	50	600
Ø 12x75	SLNZ12075	£106.60	25	75	M10	12	55	50	90	40	25	300
Ø 12x99	SLNZ12099	£138.35	49	99	M10	12	55	50	90	40	25	300
Ø 12x129	SLNZ12129	£184.84	79	129	M10	12	55	50	90	40	25	150
Ø 16x65	SLNZ16065	£164.43	10	65	M12	16	65	55	100	55	25	125
Ø 16x111	SLNZ16111	£218.86	56	111	M12	16	65	55	100	55	25	125
Ø 16x147	SLNZ16147	£293.71	92	147	M12	16	65	55	100	55	20	100

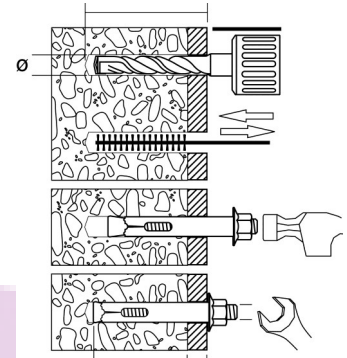

Tfix	Thickness of fixture (mm)
L	Total anchor length (mm)
d	Anchor Thread Diameter (mm)
do	Drill hole diameter (mm)
h1	Depth of drilled hole deep point (mm)
hnom	Anchor Embedment depth (mm)
hmin	Minimum structural thickness (mm)
Tinst	Recommended setting torque (kN)
Freck	Recommended Tensile/Shear Load (kN)

TECHNICAL DATA

Size	Tensile kN	Shear kN	Critical spacing distance Scr	Critical edge distance Ccr
Ø 8 - M6	2.2	1.6	120	60
Ø 10 - M8	3.4	5	140	70
Ø 12 - M10	4.3	7.8	180	90
Ø 16 - M12	5.2	9.8	200	100

Recommended loads tested in Concrete C25.

All dimensions in mm, Unless otherwise stated